

REV	DATE	DESCRIPTION	ECO	SIGN

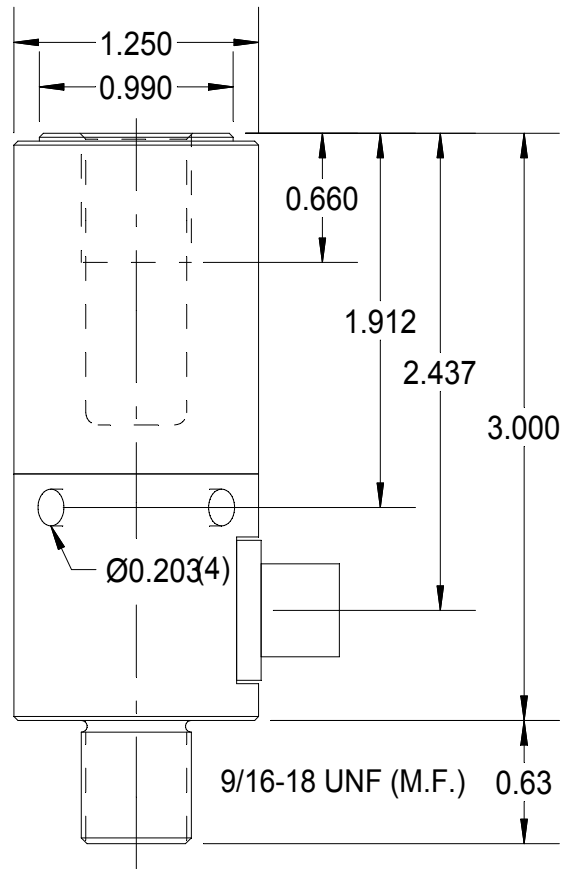

SPECIFICATIONS:

RATED CAPACITY	20,000 N
RATED OUTPUT, matched	2.00 ± 0.01 mV/V
COMBINED ERROR	± 0.25 %
NON-REPEATABILITY	< 0.05 %
ZERO BALANCE	± 1 %
TEMPERATURE RANGE, COMPENSATED	+60 TO 160° F
TEMPERATURE EFFECT, OUTPUT	0.0005 % of Load / ° F
TEMPERATURE EFFECT, ZERO BALANCE	Not rated
INPUT IMPEDANCE	350 typical
OUTPUT IMPEDANCE	350 OHMS, typical
EXCITATION VOLTAGE (typical)	10 VDC or VAC rms
EXCITATION VOLTAGE, MAXIMUM	15 VDC or VAC rms
INSULATION RESISTANCE	5,000 MEG OHMS @ 50 VDC
MAXIMUM LOAD, SAFE	150 % F.S.
MAXIMUM LOAD, ULTIMATE	300 % F.S.
DEFLECTION AT RATED CAPACITY, APPROXIMATE	0.002 in.
CONSTRUCTION	STAINLESS STEEL COVER, TOOL STEEL ELEMENT

USE FRACTIONAL FIXED HEAD-PIN STYLE SPANNER WRENCH.
McMASTER-CARR NO. 5475A12.

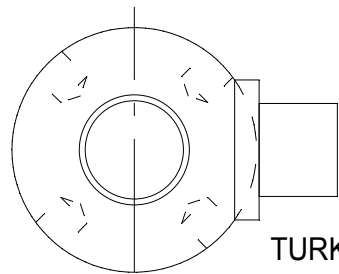

TURK FS 4.5 / 18.25

PIN COLOR CODE:

- 1 + EXC.
- 2 - SIG.
- 3 - EXC.
- 4 + SIG.
- 5 1 WIRE

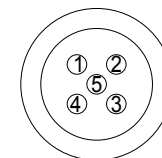

FRONT

SHLD. < 1 OHM to ELEMENT



TOLERANCES UNLESS OTHERWISE SPECIFIED:

.XXX = ± 0.005
.XX = ± 0.015
.X = ± 0.025

SCALE: FULL

FINISH: 32 MICRO INCH OR LESS



TOLEDO
TRANSDUCERS,
INC.

Designed By: **Mettert**

Date: **1/2/02**

Drawn By:

Date:

Approved By:

Date:

Title / Description:

**SS1396-20kN INSERTION
LOAD CELL SPECIFICATIONS**

Dwg. Size:
A

Dwg. Type:
SPEC

Page 1 of 1

Part No. **SS1396**

File Name **12464SP.FCD**

Doc. No. **12464**