

REV	DATE	DESCRIPTION	ECO	SIGN
1	2/2/05	RELEASE TO PILOT	1282	JLM

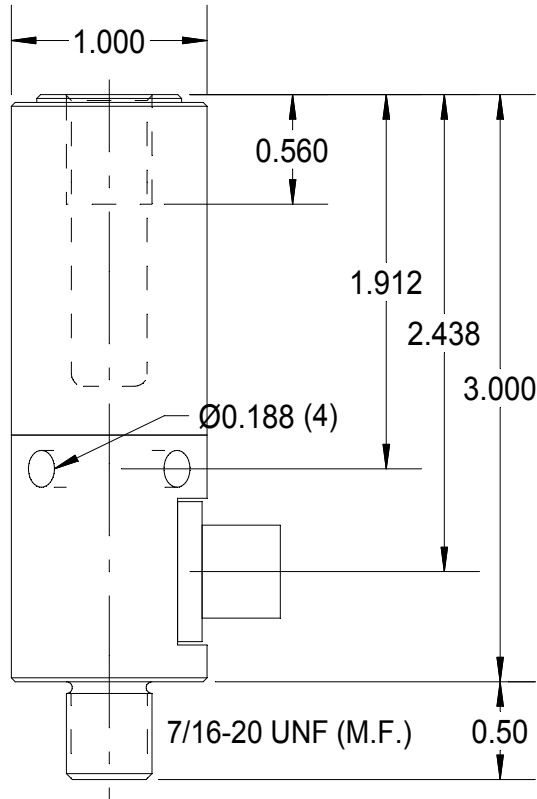

USE FRACTIONAL FIXED HEAD-PIN STYLE SPANNER WRENCH.  
McMASTER-CARR NO. 5475A11.

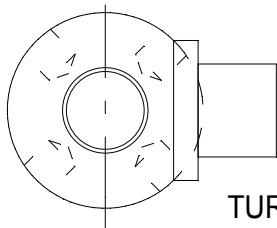

TURK FS 4.5 / 18.25

SPECIFICATIONS:

RATED CAPACITY	10,000 N
RATED OUTPUT, matched	2.00 ± 0.01 mV/V
COMBINED ERROR	± 0.25 %
NON-REPEATABILITY	< 0.05 %
ZERO BALANCE	± 1 %
TEMPERATURE RANGE, COMPENSATED	+60 TO 160° F
TEMPERATURE EFFECT, OUTPUT	0.0005 % of Load / ° F
TEMPERATURE EFFECT, ZERO BALANCE	Not rated
INPUT IMPEDANCE	1,000 typical
OUTPUT IMPEDANCE	1,000 OHMS, typical
EXCITATION VOLTAGE (typical)	10 VDC or VAC rms
EXCITATION VOLTAGE, MAXIMUM	15 VDC or VAC rms
INSULATION RESISTANCE	5,000 MEG OHMS @ 50 VDC
MAXIMUM LOAD, SAFE	150 % F.S.
MAXIMUM LOAD, ULTIMATE	300 % F.S.
DEFLECTION AT RATED CAPACITY, APPROXIMATE	0.002 in.
CONSTRUCTION	STAINLESS STEEL COVER, TOOL STEEL ELEMENT

PIN COLOR CODE:

- 1 + EXC.
- 2 - SIG.
- 3 - EXC.
- 4 + SIG.
- 5 1 WIRE

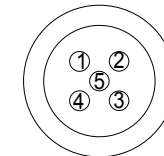

FRONT

SHLD. < 1 OHM to ELEMENT



TOLERANCES UNLESS OTHERWISE SPECIFIED:

.XXX = ± 0.005  
.XX = ± 0.015  
.X = ± 0.025

SCALE: FULL

FINISH: 32 MICRO INCH OR LESS



TOLEDO  
TRANSDUCERS,  
INC.

Designed By: **Mettert**

Date: 1/2/02

Drawn By:

Date:

Approved By:

Date:

Title / Description:

SS1395-10kN INSERTION  
LOAD CELL SPECIFICATIONS  
TOX P.N. ZLC0010

Dwg. Size:  
A

Dwg. Type:  
SPEC

Page 1 of 1

Part No. SS1395

File Name 12459SP.FCD

Doc. No. 12459