

REV	DATE	DESCRIPTION	ECO	SIGN

20 FOOT LONG CABLE

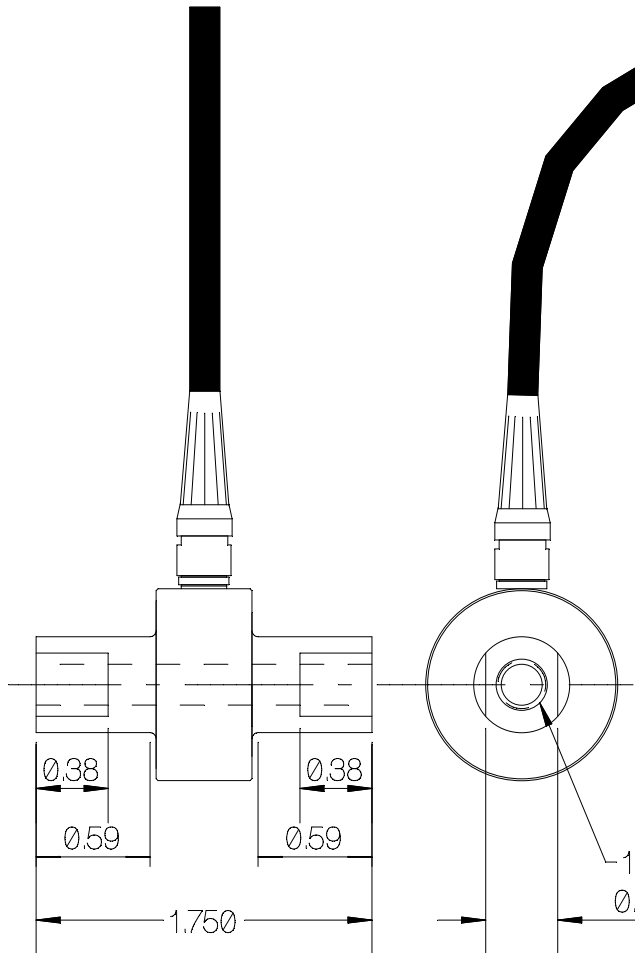

SPECIFICATIONS:

Rated Capacity	500 pounds
Rated Output, typical	2 mV/V
Combined error	0.25 % F.S.
Non-repeatability	0.05 % F.S.
Zero Balance	1 % R.O.
Temperature Range, Compensated	50 F to 120 F
Temperature Effect, Output	0.005 % of load / F
Temperature Effects, Zero Balance	0.005 % / R.O. / F
Bridge Impedance, Typical	350 ohms
Excitation Voltage, Typical	10 VDC or VAC rms
Excitation Voltage, Maximum	15 VDC or VAC rms
Insulation Resistance	> 5,000 megohms at 50 VDC
Overload, Safe	150 % over capacity
Overload, Ultimate	200 % over capacity
Construction	Aluminum
Frequency Response	11,000 Hz

WIRE COLOR CODE:

+ EXCITATION	RED
- EXCITATION	BLACK
+ SIGNAL	WHITE
- SIGNAL	GREEN
SHIELD	FLOATS AT CELL

TOLERANCES UNLESS OTHERWISE SPECIFIED:

XXX = ± 0.005

XX = ± 0.015

X = ± 0.025

SCALE: FULL

FINISH: 32 MICRO INCH OR LESS

MAT'L: 2024-T351

HARDNESS: T351



TOLEDO
TRANSDUCERS,
INC.

Designed By: Mettert

Date: 1/26/00

Drawn By:

Date:

Approved By:

Date:

Title / Description:

SS1321-500 Lb. COMPRESSION
TENSION UNIVERSAL
LOAD CELL SPECIFICATIONS

Dwg Size:

Dwg. Type:

Page 1 of 1

Part No. SS1321-500LB

File Name 11555SP.FCD

Doc. No. 11555