

REV	DATE	DESCRIPTION	ECO	SIGN
1	11/21/96	RELEASE FOR QUOTING PURPOSES	437	RAB

WIRE COLOR CODE:

- + EXCITATION                   YELLOW
- EXCITATION                   BLACK
- + SIGNAL                        WHITE
- SIGNAL                        RED
- SHIELD                        1 OHM TO ELEMENT\*

\*(DYNAMIC LOAD CELL USED WITH T.T.I. PRODUCTION / LOAD MONITOR.)

INSTALLATION TORQUE SHOULD NOT EXCEED 525 IN-LB ON THIS END OF LOAD CELL

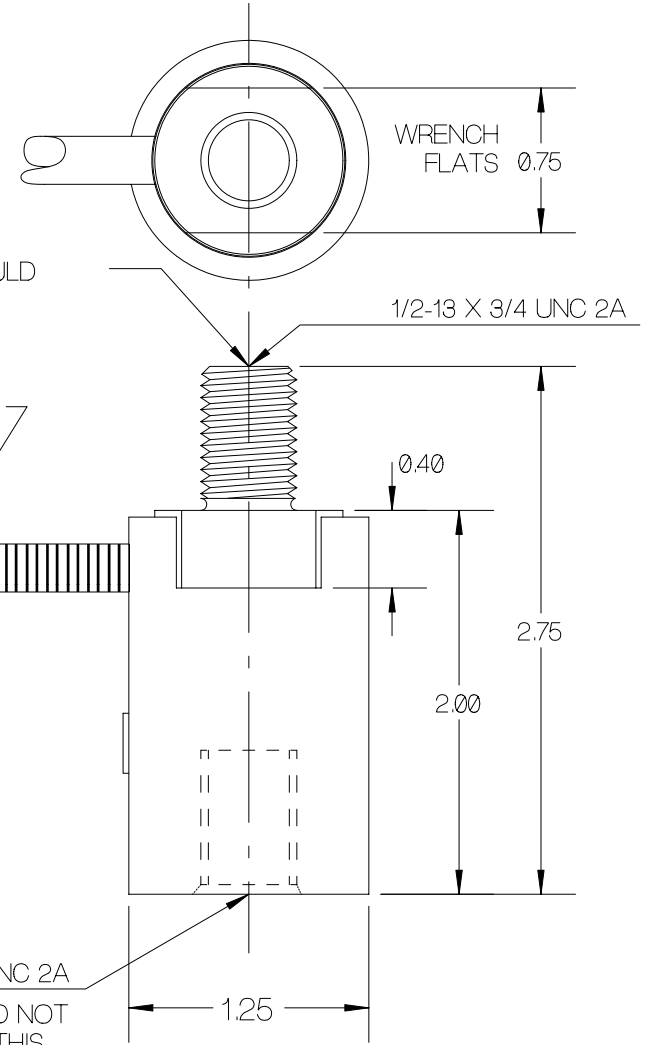
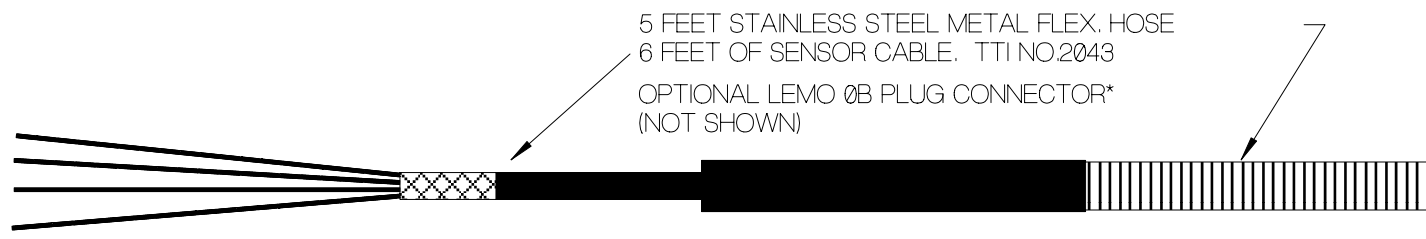

TOOL TORQUE SHOULD NOT EXCEED 250 IN-LB ON THIS END OF LOAD CELL

SPECIFICATIONS:

RATED CAPACITY	1,000 POUNDS
RATED OUTPUT	2 mV/V typical
COMBINED ERROR	0.25 %
NON-REPEATABILITY	0.05 %
ZERO BALANCE	± 1 %
TEMPERATURE RANGE, COMPENSATED	+14 TO 104° F
TEMPERATURE EFFECT, OUTPUT	0.014 % / ° F
TEMPERATURE EFFECT, ZERO BALANCE	0.05 % / ° F
INPUT IMPEDANCE	350 OHMS, typical
EXCITATION VOLTAGE (typical)	10 VDC or VAC rms
EXCITATION VOLTAGE, MAXIMUM	15 VDC or VAC rms
INSULATION RESISTANCE	5,000 MEG OHMS @ 50 VDC
MAXIMUM LOAD, SAFE	300 % F.S.
MAXIMUM LOAD, ULTIMATE	600 % F.S.

TOLERANCES UNLESS OTHERWISE SPECIFIED:	
.XXX = ± 0.005	SCALE: FULL
.XX = ± 0.015	
.X = ± 0.025	
FINISH: FINE BRUSHED FINISH, O.D. NO MARKS	
MATL: ALLOY STEEL / STAINLESS STEEL	



Designed By:	<b>Mettert</b>	Date:	<b>11/15/96</b>
Drawn By:		Date:	
Approved By:		Date:	

Title / Description:	
<b>INSERTION LOAD CELL SPECIFICATIONS</b>	
Dwg. Size:	Dwg. Type:
<b>A</b>	<b>SPEC</b>
Page 1 of 1	

Part No.	<b>SS1122-1K</b>
File Name	<b>10156SP.FCD</b>
Doc. No.	<b>10156</b>